

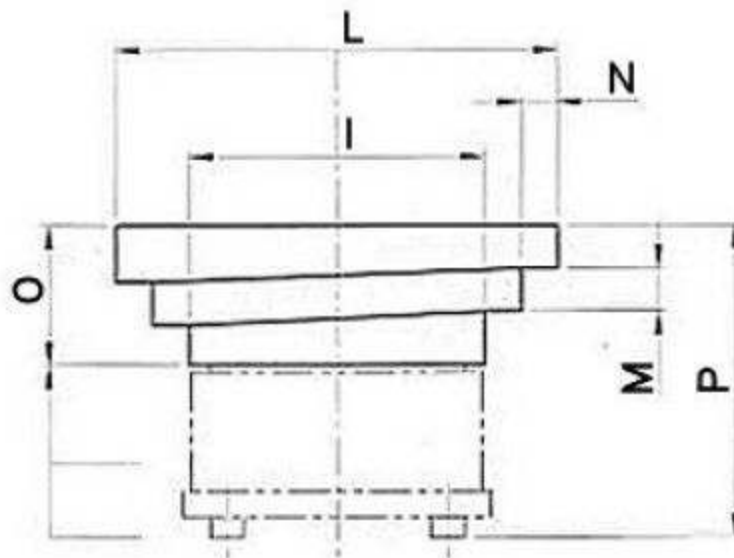

PERMARIND

**brovind**<sup>®</sup>

## Stepped bowls for circular feeders



Summary table:

Model	l (Ø min)	L (Ø max)	M (step)	N (coil)	O	P	Weight
<b>OB-150</b>	145	245	35	20	90	230	2,5
<b>OB-300</b>	250 - 230	350 - 380	45 - 50	20 - 30	105 - 125	320	5,4
<b>OB-500</b>	355 - 375	480 - 550	60 - 70	25 - 35	155 - 175	440	14
<b>OB-600</b>	450 - 410	600 - 660	70 - 80	30 - 50	160 - 180	470	19,5
<b>OB-850</b>	500 - 500	800 - 950	100 - 120	60 - 90	250 - 325	600	40
<b>OB-1000</b>	550 - 600	900 - 1100	120 - 130	70 - 100	305 - 325	840	61



234 661 888



917 390 183



234 661 889



comercial@permarind.com



Apartado 453 • 3754-909 • Águeda • Vale do Grou • E.N. 1 • Portugal



www.permarind.com