

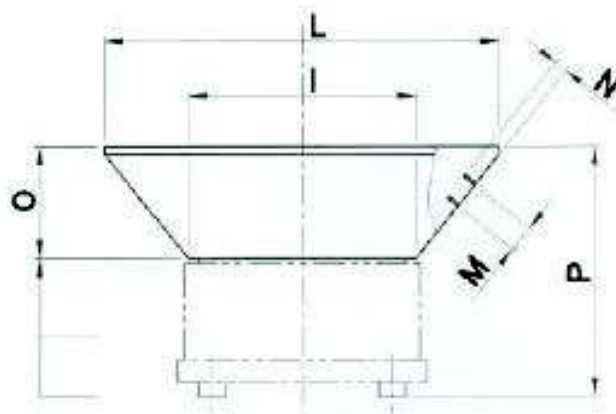

PERMARIND

brovind[®]

Conical bowls for circular feeders



Summary table:

Stainless steel

Model	I (Ø min)	L (Ø max)	M (step)	N (coil)	O	P	Weight
OB-150	140	250	30	10	95	232	3,5
OB-300	250	430	60	10	145	340	8
OB-500	310	560	80	12	180	455	15
OB-600	420	730	120	15	210	480	23
OB-850	520	900	120	20	260	610	36



234 661 888



917 390 183



234 661 889



comercial@permarind.com



Apartado 453 • 3754-909 • Águeda • Vale do Grou • E.N. 1 • Portugal



www.permarind.com