

- LSF07 is a high speed model for precision grinding and polishing. LSF07 is delivered with a 3 mm collet and can be equipped with a 1/8" collet as optional. (Without speed governor)
- LSF12/LSV12 – Small and comfortable die grinder with up to 360 W for maximum control in cramped spaces. All models are delivered with speed governor and a well balanced 6 mm Erickson collet.
- LSF19/LSV19 – All models in the 19 series are equipped with a powerful 0.5 kW air motor and a speed governor. The angled models (LSV) have a patented solution that overcomes temperature and leakage problems commonly associated with angle head tools. The result is a leak free and self-cooled angle head. All models are lubrication free except for the high speed model LSF19 S460.
- LSF28/LSV28 – Powerful 0.85 kW air motor, with speed governor and scatter damping. Impressive power-to-weight ratio.



- LSF38 – One of the most powerful one hand die grinders on the market, up to 1.35 kW. The die grinders in the 38

series are lubrication free with scatter damping for maximum operator comfort and safety.

Model	Max free speed /min	Rec. max dia of Tungsten Mount-carbide		Max output		Weight kg	Length lb	mm	Air consumption at				Rec. hose size mm in	Air inlet thread BSP	Collet size	Ordering No.	
		burrs mm	points mm	kW	hp				max output l/s	free speed cfm	l/s	cfm					
<b>Straight die grinders</b>																	
LSF12 S400-1 <sup>a</sup>	40000	9	16	0.36	0.48	0.4	0.8	170	9.8	20.8	7.0	14.8	8	5/16	1/4	6 mm	8423 1124 04
LSF12 S310-1 <sup>a</sup>	31000	12	20	0.32	0.43	0.4	0.8	170	9.2	19.5	4.2	8.9	8	5/16	1/4	6 mm	8423 1124 03
LSF12 S250-1 <sup>a</sup>	25000	12	20	0.29	0.39	0.4	0.8	170	8.5	18.0	3.4	7.2	8	5/16	1/4	6 mm	8423 1124 02
LSF12 S200-1 <sup>a</sup>	20000	12	20	0.24	0.32	0.4	0.8	170	8.1	17.2	2.6	5.5	8	5/16	1/4	6 mm	8423 1124 01
LSF19 S460E-1/R	46000	9	16	0.51	0.68	0.7	1.5	293	11.4	24.0	15.0	31.5	10	3/8	1/4	6 mm	8423 1224 90
LSF19 S460-1	46000	9	16	0.51	0.68	0.5	1.1	193	11.4	24.0	15.0	31.5	10	3/8	1/4	6 mm	8423 1224 82
LSF19 S460E-1	46000	9	16	0.51	0.68	0.7	1.5	293	11.4	24.0	15.0	31.5	10	3/8	1/4	6 mm	8423 1224 87
LSF19 S300-1	30000	12	20	0.50	0.67	0.5	1.1	193	11.3	23.7	6.6	13.8	10	3/8	1/4	6 mm	8423 1224 81
LSF19 S300-2	30000	12	20	0.50	0.67	0.5	1.1	193	11.3	23.7	6.6	13.8	10	3/8	1/4	1/4 in	8423 1224 84
LSF19 S300-1/R	30000	12	20	0.50	0.67	0.5	1.1	193	11.3	23.7	6.6	13.8	10	3/8	1/4	6 mm	8423 1224 89
LSF19 S300E-1	30000	12	20	0.50	0.67	0.7	1.5	293	11.3	23.7	6.6	13.8	10	3/8	1/4	6 mm	8423 1224 86
LSF19 S300E-1/R	30000	12	20	0.50	0.67	0.7	1.5	293	11.3	23.7	6.6	13.8	10	3/8	1/4	6 mm	8423 1224 88
LSF19 S200-1	20000	12	20	0.50	0.67	0.5	1.1	193	9.6	20.1	3.5	7.4	10	3/8	1/4	6 mm	8423 1224 80
LSF19 S200-2	20000	12	20	0.50	0.67	0.5	1.1	193	9.6	20.1	3.5	7.4	10	3/8	1/4	1/4 in	8423 1224 83
LSF19 S200E-1	20000	12	20	0.50	0.67	0.7	1.5	293	9.6	20.1	3.5	7.4	10	3/8	1/4	6 mm	8423 1224 85
LSF28 S250 <sup>a</sup>	25000	12	32	0.86	1.15	0.8	1.7	213	18.5	39.2	11.0	23.3	13	1/2	3/8	6 mm	8423 1235 11
LSF28 S250E <sup>a</sup>	25000	12	32	0.86	1.15	1.3	2.8	338	18.5	39.2	11.0	23.3	13	1/2	3/8	6 mm	8423 1235 60
LSF28 S250E-R <sup>a</sup>	25000	12	32	0.86	1.15	1.3	2.8	338	18.5	39.2	11.0	23.3	13	1/2	3/8	6 mm	8423 1235 49
LSF28 S250-R <sup>a</sup>	25000	12	32	0.86	1.15	0.8	1.7	213	18.5	39.2	11.0	23.3	13	1/2	3/8	6 mm	8423 1235 48
LSF28 S180	18000	16	40	0.82	1.10	0.8	1.7	213	17.4	36.9	7.0	14.8	13	1/2	3/8	6 mm	8423 1235 04
LSF28 S180E	18000	16	40	0.82	1.10	1.3	2.8	338	17.4	36.9	7.0	14.8	13	1/2	3/8	6 mm	8423 1235 05
LSF28 S180E-1R	18000	16	40	0.82	1.10	1.3	2.8	338	17.4	36.9	7.0	14.8	13	1/2	3/8	6 mm	8423 1235 42
LSF28 S180-1R	18000	16	40	0.82	1.10	0.8	1.7	213	17.4	36.9	7.0	14.8	13	1/2	3/8	6 mm	8423 1235 41
LSF28 S150	15000	16	40	0.70	0.94	0.8	1.7	213	15.0	31.8	5.5	11.7	13	1/2	3/8	6 mm	8423 1235 64
LSF28 S150E	15000	16	40	0.70	0.94	1.3	2.8	338	15.0	31.8	5.5	11.7	13	1/2	3/8	6 mm	8423 1235 61
LSF28 S120	12000	16	40	0.66	0.89	0.8	1.7	213	13.8	29.3	4.0	8.5	13	1/2	3/8	6 mm	8423 1235 67
LSF38 S250E-01 <sup>a</sup>	25000	16	40	1.35	1.80	1.5	3.3	356	28.0	58.0	25.0	53.0	13	1/2	3/8	6 mm	8423 1231 17
LSF38 S180E-01	18000	16	40	1.35	1.80	1.5	3.3	356	28.0	58.0	15.0	31.0	13	1/2	3/8	6 mm	8423 1231 16
LSF38 S180E-01/R	18000	16	40	1.35	1.80	1.5	3.3	356	28.0	58.0	15.0	31.0	13	1/2	3/8	6 mm	8423 1231 15
LSF38 S150E-01/R	15000	16	40	1.25	1.70	1.5	3.3	356	24.0	50.0	13.0	27.0	13	1/2	3/8	6 mm	8423 1231 14
<b>Angle die grinders</b>																	
LSV12 S200-1 <sup>a</sup>	20000	12	20	0.29	0.39	0.5	1.2	166	9.5	20.1	6.4	13.6	8	5/16	1/4	6 mm	8423 1124 06
LSV12 S120-1 <sup>a</sup>	12000	12	20	0.24	0.33	0.5	1.2	166	8.3	17.6	3.0	6.4	8	5/16	1/4	6 mm	8423 1124 05
LSV19 S200-1	20000	12	20	0.46	0.62	0.6	1.3	185	11.3	23.9	7.5	15.9	10	3/8	1/4	6 mm	8423 0111 41
LSV19 S120-1	12000	12	20	0.46	0.62	0.6	1.3	185	11.3	23.9	7.5	15.9	10	3/8	1/4	6 mm	8423 0111 43
LSV19 S080-1	8000	12	20	0.37	0.50	0.6	1.3	185	11.3	23.9	6.5	13.8	10	3/8	1/4	6 mm	8423 0111 46
LSV28 S150	15000	16	40	0.68	0.91	1.2	2.5	250	17.0	36.0	8.3	17.6	10	3/8	3/8	6 mm	8423 0125 54

<sup>a</sup> Not lubrication-free.

E = Extended version R = Model is rigid, without scatter damping

Continued....

Model	Max free speed r/min	Rec. max dia of		Max output		Weight			Air consumption at				Rec. hose size		Air inlet	Collet size	Ordering No.	
		Tungsten carbide burrs mm	Mounted points mm	kW	hp	kg	lb	mm	max output l/s	free speed l/s	free speed cfm	mm	in	thread BSP				
<b>Grinders for polishing</b>																		
LSF28 ST030	3000	—	—	0.67	0.90	1.2	2.6	257	18.0	38.2	8.6	18.2	10	3/8	3/8	6 mm	8423 1235 63	
LSF28 ST030E	3000	—	—	0.67	0.90	1.8	3.9	383	18.0	38.2	8.6	18.2	10	3/8	3/8	6 mm	8423 1235 62	
LSF28 ST070 <sup>a</sup>	7000	—	—	0.76	1.02	1.2	2.6	257	18.9	40.1	12.4	23.6	10	3/8	3/8	6 mm	8423 1235 66	
LSF28 ST070E <sup>a</sup>	7000	—	—	0.76	1.02	1.8	3.9	383	18.9	40.1	12.4	23.6	10	3/8	3/8	6 mm	8423 1235 65	
<b>High speed pen model</b>																		
LSF07 S850	88000	4	6	0.10	0.10	0.4	0.9	173	2.2	4.9	2.3	4.6	4.5	3/16	—	3 mm	8423 1222 03	

<sup>a</sup> Not lubrication-free.

E = Extended version

R = Model is rigid, without scatter damping

## Accessories Included

LSF07	LSF/LSV12	LSF/LSV19/28	LSF38
Air hose, ErgoNIP 08, Collet 3 mm (See ill. 1.)	Spanner, Collet 6 mm (See ill. 1), Air hose, Air hose nipple and clamp, Exhaust hose	Spanner, Collet 6 mm (See ill. 1.), Air hose, Air hose nipple and clamp, Exhaust hose	Air hose nipple, Collet 6 mm (See ill. 1.)

## Optional Accessories

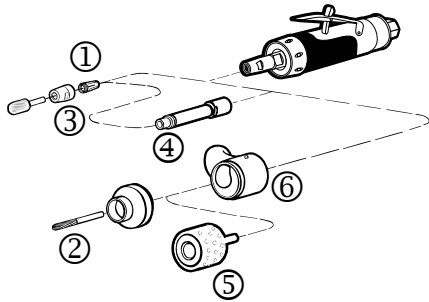

LSF07, LSF/LSV12

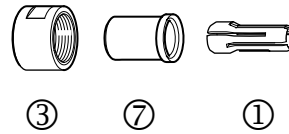

	LSF07	LSF/LSV12	LSF/LSV19	LSF/LSV28	LSF38	See ill.
<b>Optional collets</b>						
Collet 1/8"	4150 1822 00	4150 2226 46	-	-	-	1
Collet 3 mm	4150 1800 00	-	4150 0081 00	4150 0081 00	-	1
Collet 6 mm	-	4150 2226 03	4150 0075 00	4150 0075 00	4150 1453 00	1
Collet 8 mm	-	-	4150 0074 00	4150 0074 00	4150 0706 00	1
Collet 1/4"	-	-	4150 0076 00	4150 0076 00	4150 1754 00	1
Collet 10 mm	-	-	-	-	4150 0681 00	1
Collar	-	4150 2226 02	-	-	-	7
Collet nut	-	4150 2226 04	4150 0760 00	4150 0760 00	4150 0849 00	3
Collet nut and holder	-	-	-	4110 0844 90	-	-
Extension 75 mm/3"	-	-	4150 0674 00 <sup>a</sup>	4150 0674 00 <sup>a</sup>	-	4
<b>For machining of plastic and fibre glass</b>						
Diamond burr Ø 6 mm	-	3780 5013 70	3780 5013 70	3780 5013 70	-	2
Diamond drum Ø 27 mm	-	-	3780 5033 00	-	-	5
Diamond drum Ø 52 mm	-	-	-	3780 5035 00	-	5
Spot suction kit for burr (burr not included)	-	3780 3015 23	3780 3015 22	3780 4007 42	-	6
Spot suction kit for drum (drum not included)	-	-	3780 4011 61 <sup>b</sup>	3780 4011 73 <sup>c</sup>	-	6

<sup>a</sup> Only for rigid (-R) models

<sup>b</sup> For use with 6 mm collet

<sup>c</sup> For use with 8 mm collet

## Productivity Kits

Model	Air inlet BSP	Max air flow	Hose, 5 m	Coupling	Lubrication	Ordering No.
MIDI Optimizer F/RD EQ10-R13-W, incl. whiphose	3/8	23 l/s	Rubair 13 mm	ErgoQIC 10	Yes	8202 0850 14
MIDI Optimizer F/RD EQ10-R13-W, incl. whiphose	-	23 l/s	Rubair 13 mm	ErgoQIC 10	Yes	8202 0850 15
MIDI Optimizer F/RD EQ10-T13	3/8	35 l/s	Turbo 13 mm	ErgoQIC 10	Yes	8202 0850 17
MIDI Optimizer F/R EQ10-T13	1/2	35 l/s	Turbo 13 mm	ErgoQIC 10	No	8202 0850 04
MIDI Optimizer F/RD EQ10-T13	1/2	35 l/s	Turbo 13 mm	ErgoQIC 10	Yes	8202 0850 13



## Service Kits

07 series 4081 0243 90    12 series 4081 0472 90    19 series 4081 0486 90    28 series 4081 0315 90    38 series 4081 0308 90

Atlas Copco straight grinders for cone wheel or collet, are suitable for grinding in holes and cavities in castings. They require rough abrasives, which must be attached to the tool with a grind shank or to be mounted directly to the spindle.

The power ranges from 0.7 kW to 2 kW. All Atlas Copco tools are designed with focus on operator ergonomics and maximum power, the best combination for maximum productivity.

- The LSR28 and 38 are suitable for lighter applications where accessibility is first priority.
- LSR43 has a proven and rigid design, and is suitable for those really tough applications where durability is needed.
- If you need maximum power, then LSR48 is the natural choice. You will have access to 2 kW in combination with an autobalancer for even less vibrations.



Model	Max free speed r/min	Max output		Weight		Length mm	Air consumption at				Rec. hose size		Air inlet thread BSP	Ordering No.
							max output		free speed					
							kW	hp	kg	lb	l/s	cfm	l/s	
LSR28 S150-CW	15000	0.70	0.94	1.2	2.6	304	18.0	38.2	5.8	12.3	13	3/8	3/8	8423 1325 06
LSR28 S120-CW	12000	0.66	0.88	1.2	2.6	304	15.8	33.5	4.3	8.6	13	3/8	3/8	8423 1325 05
LSR38 S180-CW	18000	1.35	1.80	1.5	3.3	323	28.0	58.0	15.0	31.0	13	3/8	3/8	8423 1232 30
LSR38 S150-CW	15000	1.25	1.70	1.5	3.3	323	24.0	50.0	13.0	27.0	13	3/8	3/8	8423 1232 31
LSR43 S150-30C <sup>a</sup>	15000	1.0	1.3	2.1	4.6	503	23.0	49.0	10.0	21.0	13	1/2	1/2	8423 1432 33
LSR43 S120-30 <sup>a</sup>	12000	0.9	1.2	2.0	4.4	438	20.0	42.0	7.0	15.0	13	1/2	1/2	8423 1432 24
LSR48 S150-CW	15000	2.0	2.7	2.3	5.0	450	35.0	74.0	19.0	40.0	16	5/8	1/2	8423 1430 08
LSR48 S120-CW	12000	1.8	2.4	2.3	5.0	450	30.0	64.0	13.0	27.0	16	5/8	1/2	8423 1430 05
LSR48 S090-CW	9000	1.5	2.0	2.3	5.0	450	28.0	59.0	11.0	23.0	16	5/8	1/2	8423 1430 03

<sup>a</sup> Not lubrication free.  
-30C = With collet size 6 mm

LSR28/38 has an internal spindle thread, M12X1, and need an adapter to fit a cone wheel or a collet. Adapters are ordered separately.

LSR48 has UNC 1/2" spindle for direct attachment of a cone wheel. For UNC 5/8" spindle or collet use an adapter (not included).

## Accessories Included

### LSR28/38 CW

Air hose nipple and clamp  
Exhaust hose  
Wrenches  
Whip hose (only LSR 28)

### LSR43 30/30C

Hose nipple  
Wrench

### LSR48 CW

Whip hose  
Wrench